



Stoneacre
Properties



Barrington Way, Leeds, LS15 8FU
£1,200

Stoneacre Properties are delighted to offer to let a remarkable property that has just been built. The property is located at Thorpe Park. Thorpe Park is a new retail, commercial, leisure and residential development that is sure to transform the east of Leeds into a vibrant place to live and work. Located just off the M1. There is a luxury hotel/spa, choice of cafés and restaurants and a state of the art cinema. In addition there is 140 acres of public parks and open spaces ready to explore. This delightful Apartment comprises: entrance hall, open plan kitchen/living space, two bedrooms, ensuite shower room, bathroom and stunning balcony. There is also two allocated parking spaces one with an electric charge point and ample visitor parking. Available Now. Unfurnished.

Entrance Hall



Bathroom



External



Open Plan Kitchen/Living Space



Bedroom One



Ensuite



Bedroom Two



Floor Plan

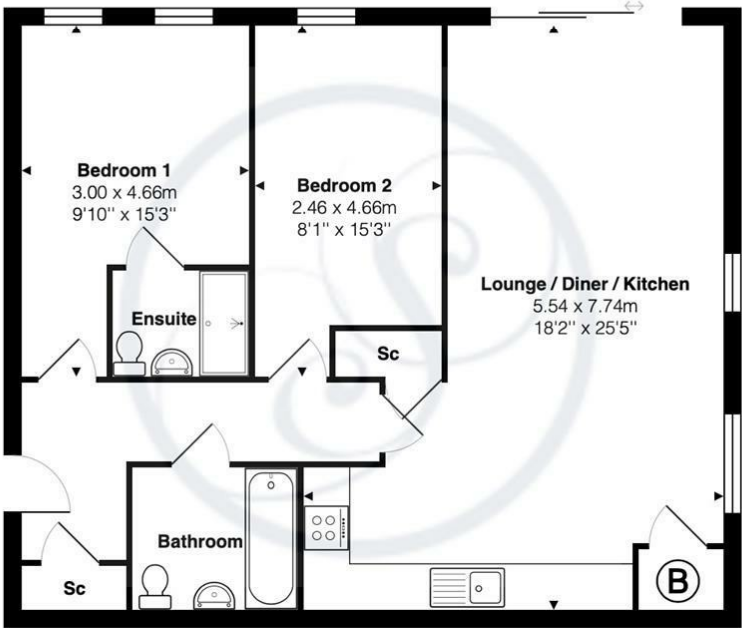

Total Area: 71.7 m² ... 771 ft²

All measurements are approximate and for display purposes only

Area Map



Energy Efficiency Graph

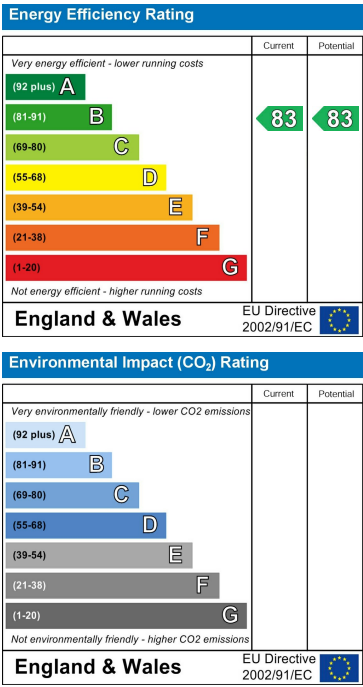

These particulars, whilst believed to be accurate are set out as a general outline only for guidance and do not constitute any part of an offer or contract. Intending purchasers should not rely on them as statements of representation of fact, but must satisfy themselves by inspection or otherwise as to their accuracy. No person in this firm's employment has the authority to make or give any representation or warranty in respect of the property.